

ORDINANCE NO. 6007

AN ORDINANCE AMENDING SECTION 11-3-2, OFFICIAL ZONING DISTRICT MAP AND DISTRICT BOUNDARIES, OF THE MESA CITY CODE, CHANGING THE ZONING OF CERTAIN PROPERTY DESCRIBED IN ZONING CASE ZON25-00942 LOCATED AT THE NORTHWEST CORNER OF WEST RIO SALADO PARKWAY AND NORTH CUBS' WAY (3.1± ACRES). REZONE FROM GENERAL COMMERCIAL (GC) TO GENERAL COMMERCIAL WITH A BONUS INTENSITY ZONE OVERLAY (GC-BIZ), COUNCIL USE PERMIT (CUP), AND SITE PLAN REVIEW AND PROVIDING PENALTIES FOR THE VIOLATION THEREOF.

BE IT ORDAINED BY THE CITY COUNCIL OF THE CITY OF MESA, MARICOPA COUNTY, ARIZONA, AS FOLLOWS:

Section 1: That Section 11-3-2, Official Zoning Map and District Boundaries, of the Mesa Zoning Ordinance is hereby amended by adopting the Official Supplementary Zoning Map for Zoning Case ZON25-00942 signed by the Mayor and City Clerk, which accompanies and is annexed to this ordinance and declared a part hereof.

Section 2: The Official Supplementary Zoning Map attached hereto is adopted subject to compliance with the following conditions:

1. Compliance with the final site plan as submitted.
2. Compliance with all applicable City development codes and regulations.
3. Compliance with all conditions of DRB25-00936.
4. Installation of all off-site improvements and street frontage landscaping during the first phase of construction.
5. Compliance with the Plan of Operation and Good Neighbor Policy submitted.
6. Prior to the submittal of any building permit, record a lot combination or a lot line adjustment to combine APNs 135-38-001N and 135-38-001M.
7. Compliance with all City development codes and regulations, except the modification to the development standards as approved with this BIZ Overlay as shown in the following table:

Development Standards	BIZ Approved
<u>Maximum Building Height</u> – MZO Table 11-6-3.A	65 feet

Development Standards	BIZ Approved
<p><u>Minimum Setbacks to Building and Parking Areas</u> – <i>MZO Table 11-6-3.A</i></p> <p>Front and Street Facing Side (adjacent to Rio Salado Parkway)</p> <p>Side and Rear adjacent to non-residential district, per story</p>	<p>11 feet</p> <p>7 feet (north side) 2.5 feet (east side) 2.5 feet (west side)</p>
<p><u>Required Landscape Yards</u> – <i>MZO Section 11-33-3 (B)(2)(a)(ii)</i></p> <p>Non-Single Residence Adjacent to other Non-Single Residence Districts</p>	<p>0 Feet</p>
<p><u>Perimeter Landscaping</u> – <i>MZO Table 11-33-3.A.4</i></p> <p><i>Arterial Streets</i></p> <p><i>Local Streets</i></p>	<p>0 Trees and Shrubs required within the proposed landscape yards</p>
<p><u>Required Parking Spaces by Use</u> – <i>MZO Table 11-32-3.A</i> - Multiple Residence</p>	<p>1.29 spaces per unit (56 spaces)</p>
<p><u>Required Parking Spaces by Use</u> – <i>MZO Section 11-32-3(D)</i> - Covered Parking</p>	<p>11 covered parking spaces on site</p>
<p><u>Minimum Private Open Space</u> – <i>MZO Section 11-5-5(A)(3)(a)</i> – Sizing - Two and Three Bedroom Units</p>	<p>60 square feet of private open space per unit</p>
<p><u>Minimum Private Open Space Above Ground Level</u> – <i>MZO Section 11-5-5(A)(3)(e)(i)(2)</i> – Minimum Width</p>	<p>5 feet wide</p>

Section 3: PENALTY.

CIVIL PENALTIES:

- A. Any owner, occupant or responsible party who is found responsible for a civil violation of this Ordinance, whether by admission, default, or after a hearing, shall pay a civil sanction of not less than \$150 or more than \$1,500, per citation. A second finding of responsibility within 24 months of the commission of a prior violation of this Ordinance shall result in a civil sanction of not less than \$250 or more than \$2,500. A third finding of responsibility within 36 months of the commission of a prior violation of this Ordinance shall result in a civil sanction of not less than \$500 or more than \$2,500. In addition to the civil sanction, the responsible party shall pay the applicable fees and charges set forth in the City's Development and Sustainability Department (Code Compliance) Schedule of Fees and Charges, and may be ordered to pay any other applicable fees and charges.
- B. The 36 month provision described above of this Section shall be calculated by the dates the violations were committed. The owner, occupant, or responsible party shall receive the enhanced sanction upon a finding of responsibility for any violation of this Chapter that was committed within 36 months of the commission of another violation for which the owner or responsible party was convicted or was otherwise found responsible, irrespective of the order in which the violations occurred or whether the prior violation was civil or criminal.
- C. Each day in which a violation of this Ordinance continues, or the failure to perform any act or duty required by this Ordinance or by the Civil Hearing Officer continues, shall constitute a separate civil offense.

HABITUAL OFFENDER:

- A. A person who commits a violation of this Ordinance after previously having been found responsible for committing three (3) or more civil violations of this Ordinance within a twenty-four (24) month period – whether by admission, by payment of the fine, by default, or by judgment after hearing – shall be guilty of a class 1 criminal misdemeanor. The Mesa City Prosecutor is authorized to file a class 1 criminal misdemeanor complaint in the Mesa City Court against habitual offenders. For purposes of calculating the twenty-four (24) month period under this Subsection, the dates of the commission of the offenses are the determining factor.
- B. Upon conviction of a violation of this Section, the Court may impose a sentence of incarceration not to exceed six (6) months in jail; or a fine not to exceed two thousand five hundred dollars (\$2,500.00), exclusive of penalty assessments prescribed by law; or both such fine and imprisonment. The Court shall order a person who has been convicted of a violation of this Section to pay a fine of not less than five hundred dollars (\$500.00) for each count upon which a conviction has been obtained. A judge shall not grant probation to or suspend any part or all of the imposition or execution of a sentence required by this Subsection except on the condition that the person pay the mandatory minimum fines as provided in this paragraph.

C. Every action or proceeding under this Section shall be commenced and prosecuted in accordance with the laws of the State of Arizona relating to criminal misdemeanors and the Arizona Rules of Criminal Procedure.

PASSED AND ADOPTED by the City Council of the City of Mesa, Maricopa County, Arizona, this 20th day of April, 2026.

Mayor

ATTEST:

City Clerk



OFFICIAL SUPPLEMENTARY ZONING MAP AMENDING THE CITY OF MESA ZONING MAP

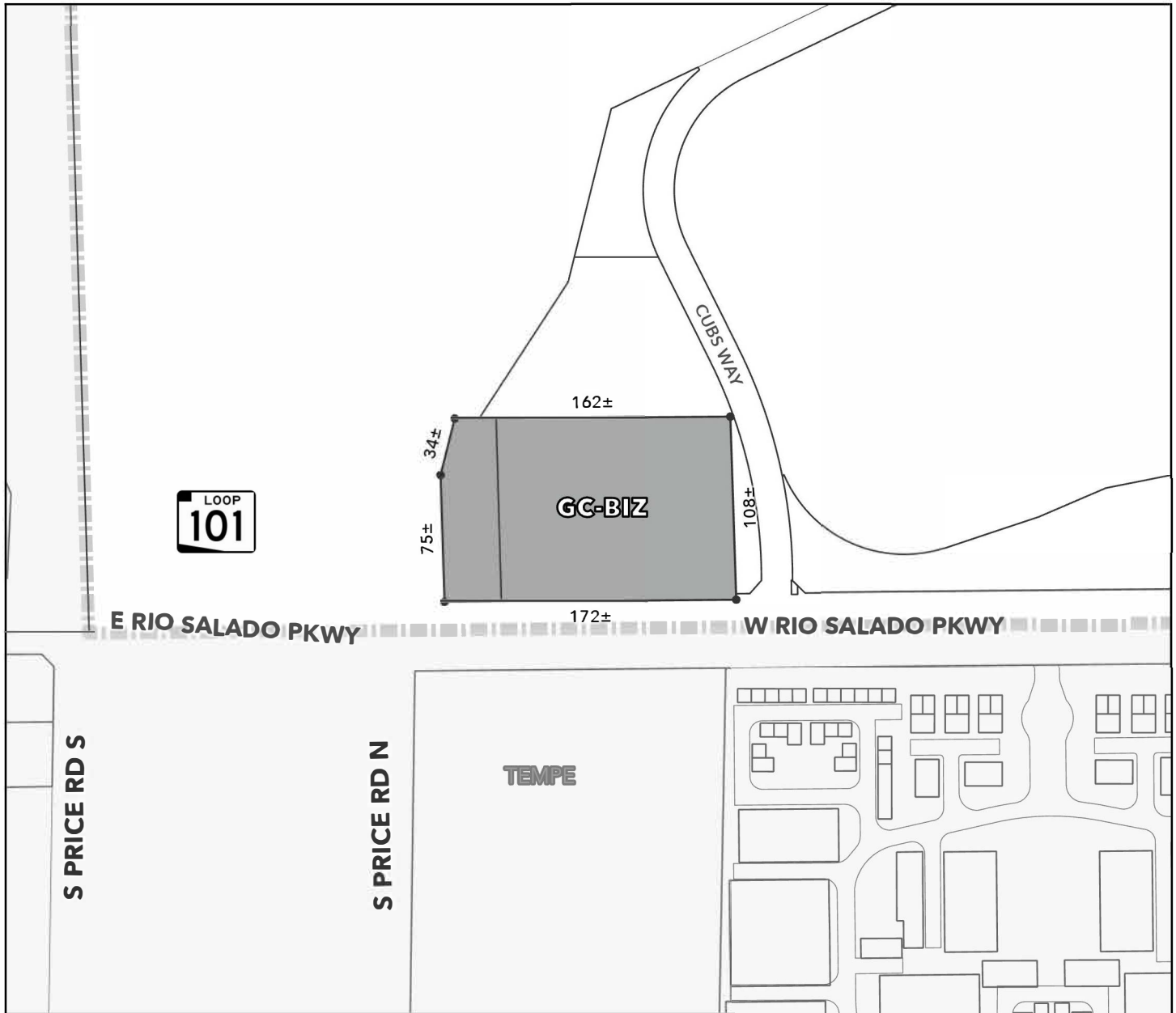

CASE: ZON25-00942

ACREAGE: 3.1±

REQUEST: Rezone from General Commercial (GC) to General Commercial with a Bonus Intensity Zone Overlay (GC-BIZ), Council Use Permit (CUP), and Site Plan Review. This request will allow for the development of an approximately 54,725± square foot hotel and 36-unit multiple residence building.

ORDINANCE: 6007

Please be advised that the attached zoning changes were approved by the Mesa City Council on April 20, 2026 by Ordinance #6007. If you have any questions concerning these changes, contact the City of Mesa Planning Division at 480-644-2385.